

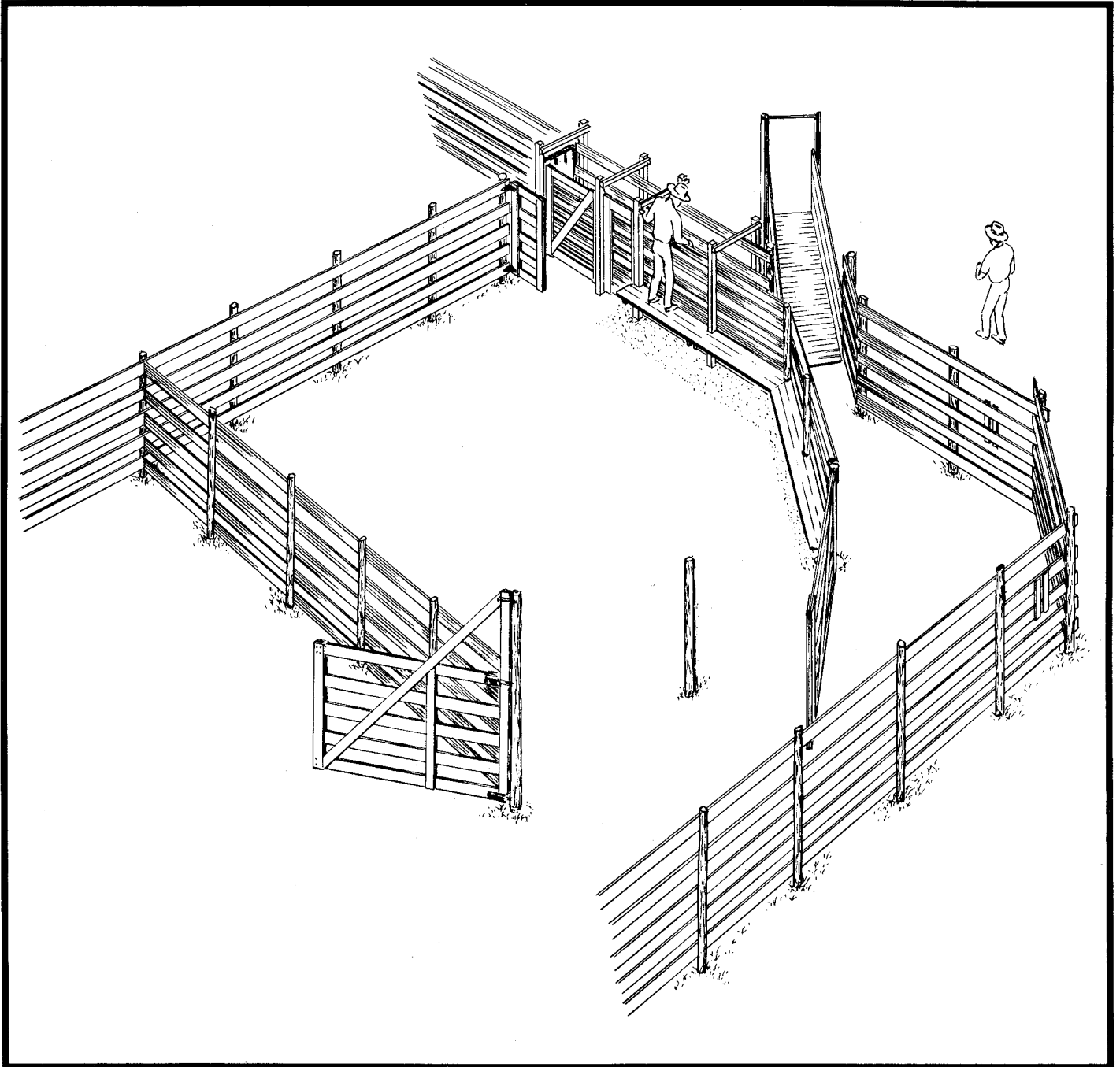

MINIMUM WORKING CORRAL



The Canada Plan Service prepares detailed plans showing how to construct modern farm buildings, livestock housing systems, storages and equipment for Canadian Agriculture. This leaflet gives the details for a farm building component or piece of farmstead equipment. To obtain another copy of this leaflet, contact your local provincial agricultural engineer or extension advisor.

MINIMUM WORKING CORRAL

PLAN M-1831 NEW 78:11

This is a minimum handling facility for the cattleman with a few head who handles cattle infrequently during a year, or for a separate pasture facility remote from the central facilities of a cow-calf operation. It consists of a holding pen, crowding area, and small working chute.

A semi-circular crowding pen with a crowding gate (leaflet

M-1812) helps squeeze animals into the chute with minimum effort. The same crowding unit can move animals into a loading chute (plan Q-1817) located adjacent to the working chute (leaflet M-1813). See leaflet M1811 for other fencing and gate details.

This corral has a short working chute (longer is preferred). It may be further equipped with a home-made headgate or a commercial squeeze with attached headgate. As the herd or the operator's needs increase this layout can be readily expanded.

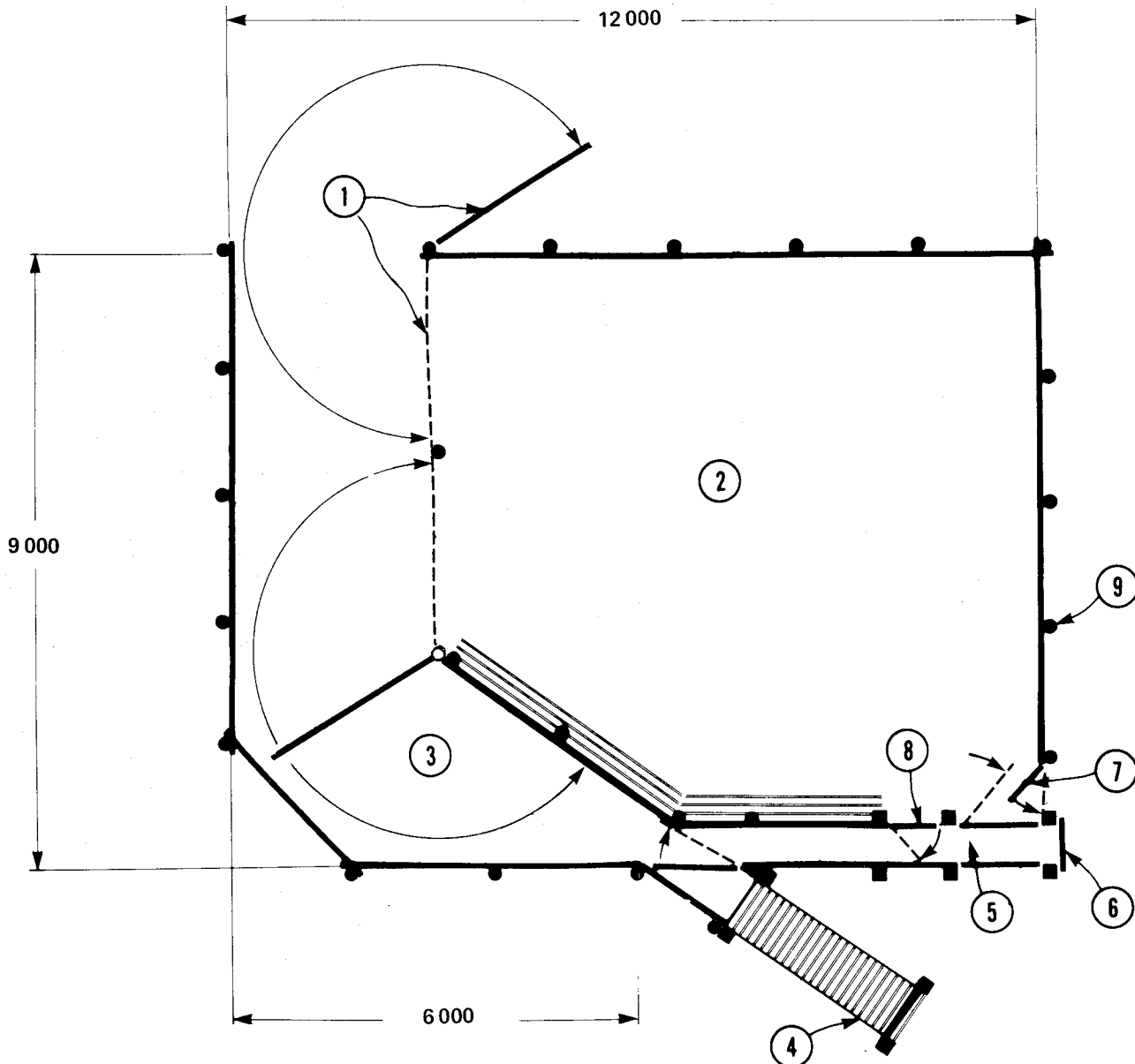

1. 3 000 mm gate (leaflet M-1811)
2. holding pen
3. crowding pen with crowding gate (leaflet M-1812)
4. loading chute (leaflet M-1816)
5. working chute (leaflet M-1813) including cattle squeeze (plan M-1189) or commercial squeeze

6. pipeframe headgate, or commercial headgate
7. access gate
8. optional man gate, same width as chute
9. posts 1 800 mm
10. ALL DIMENSIONS IN THIS METRIC PLAN ARE IN MILLI METRES (mm) UNLESS OTHERWISE SPECIFIED